



Napínačky

Turnbuckles, tensers

Napínák DIN 1480 oko-hák

povrch: galvanický zinkochromát (bílý) > 8µm

materiál: kovaná ocel S235JR, tř.4.6, Re 235MPa

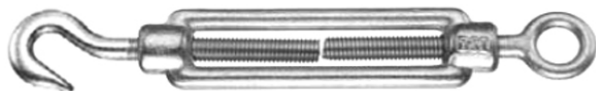

Turnbuckle DIN 1480 eye-hook

finish: galvanized > 8µm

material: forged steel St37-2

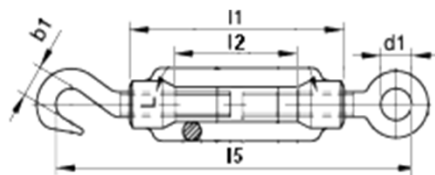

Kód Art. No.	závit thread	l1 mm	l2 mm	l5 mm	b1 mm	d1 mm	nosnost WLL kg	kg/100ks kg/100pcs	ks pcs	ks pcs
4480.A05	M5	70	50	105	8	9	60	4,7	25	500
4480.A06	M6	110	85	143	9	10	80	8,8	25	250
4480.A08	M8	110	80	157	10	12	120	14,0	15	150
4480.A10	M10	125	90	184	15	15	180	25,3	10	100
4480.A12	M12	125	85	222	16	17	260	39,1	10	50
4480.A14	M14	140	90	240	16	17	360	57,7	5	50
4480.A16	M16	170	115	272	21	23	500	86,3	5	30
4480.A20	M20	200	135	307	21	27	800	152,0	1	20
4480.A22	M22	220	145	340	23	27	1000	218,0	1	15
4480.A24	M24	255	175	390	26	30	1200	266,0	1	10
4480.A30	M30	255	165	430	30	30	1800	405,0	1	5
4480.A36	M36	295	185	480	35	35	2600	720,0	1	4

materiál: nerezavějící ocel A4

material: stainless steel AISI 316

Kód Art. No.	závit thread	l1 mm	l2 mm	l5 mm	b1 mm	d1 mm	nosnost WLL kg	kg/100ks kg/100pcs	ks pcs	ks pcs
9480.A05	M5	90	72	125	8	9	60	4,7	10	200
9480.A06	M6	110	88	140	9	10	80	8,8	10	100
9480.A08	M8	110	85	155	10	12	120	14,0	10	100
9480.A10	M10	125	93	180	15	15	180	25,3	5	50
9480.A12	M12	125	88	215	16	17	260	39,1	1	25
9480.A16	M16	170	120	260	21	23	500	57,7	1	20
9480.A20	M20	200	135	307	23	27	800	86,3	1	10

Matice pro napínák DIN 1480

povrch: galvanický zinkochromát (bílý) > 8µm

materiál: kovaná ocel S235JR, tř.4.6, Re 235MPa

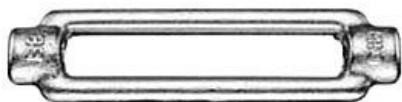

Body of turnbuckle DIN 1480

finish: galvanized > 8µm

material: forged steel St37-2

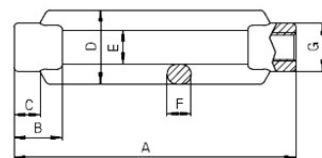

Kód Art. No.	závit thread	A mm	D mm	B = G mm	E mm	C = F mm	nosnost WLL kg	kg/100ks kg/100pcs	ks pcs	ks pcs
4480.M08	M8	110	23	15	11	8	550	9	15	150
4480.M10	M10	125	30	18	14	9	800	14	10	100
4480.M12	M12	125	34	21	16	11	1100	20	10	50
4480.M14	M14	140	38	25	18	12	1400	29	5	30
4480.M16	M16	170	42	27	20	14	1800	43	5	25
4480.M20	M20	200	52	34	24	17	2800	77	1	15
4480.M24	M24	255	60	39	28	20	4000	115	1	10
4480.M30	M30	255	74	45	34	23	5600	180	1	5
4480.M36	M36	295	86	55	40	28	7800	320	1	4

Napínák DIN 1480 oko-oko

povrch: galvanický zinkochromát (bílý) > 8µm

materiál: kovaná ocel S235JR, tř.4.6, Re 235MPa

Turnbuckle DIN 1480 eye-eye

finish: galvanized > 8µm

material: forged steel St37-2

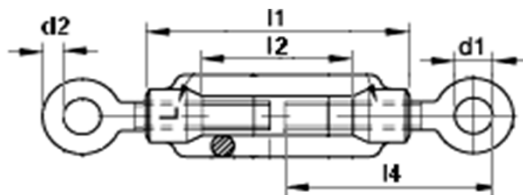
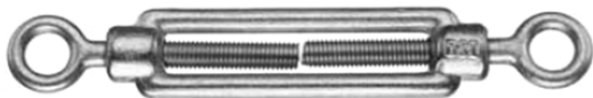

Kód Art. No.	závit thread	l1 mm	l2 mm	l4 mm	d1 mm	d2 mm	nosnost WLL kg	kg/100ks kg/100pcs	ks pcs	ks pcs
4480.B05	M5	70	50	50	9	4,0	80	4,4	25	500
4480.B06	M6	110	85	70	10	4,5	100	8,4	25	250
4480.B08	M8	110	80	75	12	5,5	150	14,5	15	150
4480.B10	M10	125	90	87	15	6,0	300	25,5	10	100
4480.B12	M12	125	85	105	17	8,0	450	39,0	10	50
4480.B14	M14	140	90	120	17	9,0	650	58,5	5	30
4480.B16	M16	170	115	137	23	11,0	800	88,0	5	25
4480.B20	M20	200	135	155	27	14,0	1200	157,0	1	15
4480.B24	M24	255	175	195	30	16,0	1800	265,0	1	10
4480.B30	M30	255	165	210	30	19,0	2800	400,0	1	5
4480.B36	M36	295	185	480	35	25,0	4000	710,0	1	4

Napínák DIN 1480 hák-hák

povrch: galvanický zinkochromát (bílý) > 8µm

materiál: kovaná ocel S235JR, tř.4.6, Re 235MPa

Turnbuckle DIN 1480 hook-hook

finish: galvanized > 8µm

material: forged steel St37-2

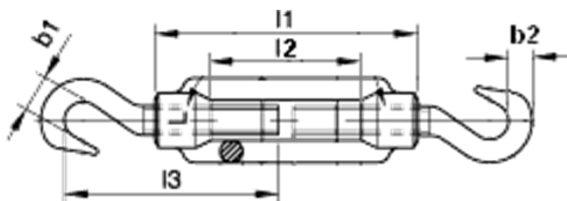

Kód Art. No.	závit thread	l1 mm	l2 mm	l3 mm	b1 mm	b2 mm	nosnost WLL kg	kg/100ks kg/100pcs	ks pcs	ks pcs
4480.C05	M5	70	50	55	8	5	60	5	25	500
4480.C06	M6	110	85	73	9	6	80	9	25	250
4480.C08	M8	110	80	82	10	8	120	16	15	150
4480.C10	M10	125	90	97	15	10	180	28	10	100
4480.C12	M12	125	85	117	16	12	260	43	10	50
4480.C14	M14	140	90	120	16	14	360	63	5	30
4480.C16	M16	170	115	135	21	17	500	94	5	25
4480.C20	M20	200	135	152	21	23	800	175	1	15
4480.C24	M24	255	175	195	26	26	1200	290	1	10
4480.C30	M30	255	165	220	30	30	1800	460	1	10
4480.C36	M36	295	185	240	30	35	2600	780	1	5

Napínák DIN 1480 k navaření

povrch: galvanický zinkochromát (bílý) > 8µm

materiál: kovaná ocel S235JR, tř.4.6, Re 235MPa



Turnbuckle DIN 1480 with stubs

finish: galvanized > 8µm

material: forged steel St37-2

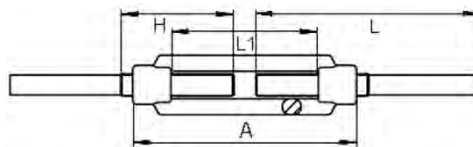

Kód Art. No.	závit thread	A mm	L1 mm	L mm	H mm	nosnost WLL kg	kg/100ks kg/100pcs	ks pcs	ks pcs
4480.E08	M8	110	80	120	65	300	16	15	150
4480.E10	M10	125	89	150	75	500	28	10	100
4480.E12	M12	125	83	150	75	700	42	10	50
4480.E14	M14	140	92	165	90	950	62	5	30
4480.E16	M16	170	116	200	100	1300	93	5	25
4480.E20	M20	200	132	220	120	2000	165	1	15
4480.E24	M24	255	177	260	150	3000	275	1	10
4480.E30	M30	255	165	260	160	4800	415	1	5
4480.E36	M36	295	185	300	180	7100	730	1	4

Napínák DIN 1480 s vidlicemi

povrch: galvanický zinkochromát (bílý) > 8µm

materiál: kovaná ocel S235JR, tř.4.6, Re 235MPa



Turnbuckle DIN 1480 with jaws

finish: galvanized > 8µm

material: forged steel St37-2

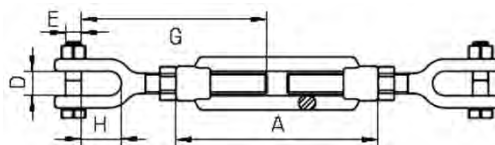

Kód Art. No.	závit thread	A mm	D mm	E mm	G mm	nosnost WLL kg	kg/100ks kg/100pcs	ks pcs	ks pcs
4480.G12	M12	125	15	M10	150	700	60	5	50
4480.G16	M16	170	20	M12	172	1300	115	5	25
4480.G20	M20	200	23	M16	185	2000	196	1	15
4480.G24	M24	255	29	M20	215	3000	339	1	10

Napínák DIN 1480 s plochými konci

povrch: galvanický zinkochromát (bílý) > 8µm

materiál: kovaná ocel S235JR, tř.4.6, Re 235MPa



Turnbuckle DIN 1480 flat

finish: galvanized > 8µm

material: forged steel St37-2

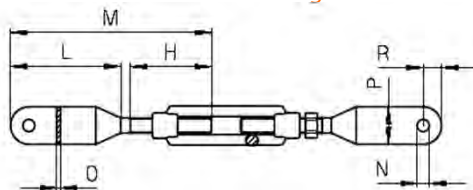

Kód Art. No.	závit thread	L mm	M mm	N mm	O mm	nosnost WLL kg	kg/100ks kg/100pcs	ks pcs	ks pcs
4480.P12	M12	75	165	13	5	700	50	5	50
4480.P16	M16	135	240	14	8	1300	105	5	25
4480.P20	M20	135	240	17	9	2000	180	1	15
4480.P24	M24	145	305	22	10	3000	310	1	10

Napínák DIN 1478 oko - hák

povrch: galvanický zinkochromát (bílý) > 8µm
materiál: kovaná ocel S235JR, tř.4.6, Re 235MPa



Turnbuckle DIN 1478 with jaws

finish: galvanized > 8µm
material: forged steel St37-2

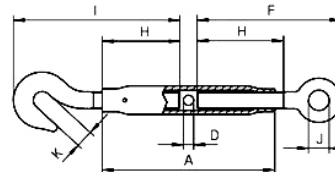

Kód Art. No.	závit thread	A mm	D mm	I mm	J mm	K mm	nosnost WLL kg	kg/100ks kg/100pcs	ks pcs	ks pcs
4478.A08	M8	110	8	98	10	11	300	30	5	80
4478.A10	M10	125	8	116	14	13	500	43	5	50
4478.A12	M12	125	10	146	16	15	700	65	5	30
4478.A16	M16	170	10	165	22	19	1300	125	1	20
4478.A20	M20	200	12	180	24	20	2000	190	1	15
4478.A24	M24	255	12	225	27	26	3000	340	1	5
4478.A30	M30	255	16	255	31	33	4800	490	1	5

Napínák DIN 1478 k navaření

povrch: galvanický zinkochromát (bílý) > 8µm
materiál: kovaná ocel S235JR, tř.4.6, Re 235MPa



Turnbuckle DIN 1478 with stubs

finish: galvanized > 8µm
material: forged steel St37-2

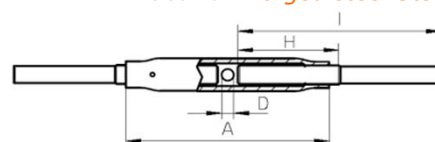

Kód Art. No.	závit thread	A mm	D mm	H mm	I mm	nosnost WLL kg	kg/100ks kg/100pcs	ks pcs	ks pcs
4478.E10	M10	125	8	75	150	500	31	5	75
4478.E12	M12	125	10	75	150	700	44	5	50
4478.E16	M16	170	10	100	200	1300	90	5	25
4478.E20	M20	200	12	120	220	2000	140	2	20
4478.E24	M24	255	12	150	260	3000	265	1	10
4478.E30	M30	255	16	160	260	4800	390	1	5
4478.E36	M36	295	16	180	300	7100	620	1	4
4478.E42	M42	330	20	200	350	9800	1000	1	2
4478.E48	M48	355	20	220	380	13000	1400	1	2

Matice napínáku DIN 1478

povrch: galvanický zinkochromát (bílý) > 8µm
materiál: kovaná ocel S235JR, tř.4.6, Re 235MPa

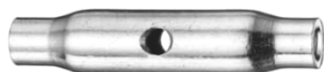

Body of turnbuckle DIN 1478

finish: galvanized > 8µm
material: forged steel St37-2

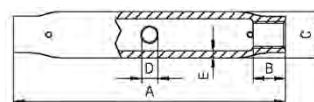

Kód Art. No.	závit thread	A mm	B mm	C mm	D mm	E mm	nosnost WLL kg	kg/100ks kg/100pcs	ks pcs	ks pcs
4478.M06	M6	110	8	17	6	3,0	780	12	10	200
4478.M08	M8	110	10	17	8	3,5	930	14	10	150
4478.M10	M10	125	12	21	8	4,0	1330	18	5	100
4478.M12	M12	125	15	25	10	4,0	1650	25	5	100
4478.M16	M16	170	20	30	10	4,5	2260	47	5	50
4478.M20	M20	200	24	34	12	5,0	2850	58	2	30
4478.M24	M24	255	29	42	12	5,5	3950	105	1	25
4478.M30	M30	255	36	51	16	6,3	5550	160	1	15
4478.M36	M36	295	43	64	16	8,0	8810	280	1	10
4478.M42	M42	330	51	70	20	9,0	10800	455	1	5
4478.M48	M48	355	58	83	20	10,0	14400	610	1	4

Napínák DIN 1478 s vydlicemi

povrch: galvanický zinkochromát (bílý) > 8µm



materiál: kovaná ocel S235JR, tř.4.6, Re 235MPa

Turnbuckle DIN 1478 with jaws

finish: galvanized > 8µm

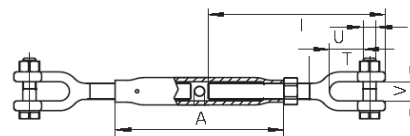

material: forged steel St37-2



Kód Art. No.	závit thread	A mm	I mm	U mm	T mm	V mm	nosnost WLL kg	kg/100ks kg/100pcs	 ks pcs	 ks pcs
4478.G08	M8	110	120	9	29	9	300	30	5	80
4478.G10	M10	125	135	9	29	11	500	43	5	50
4478.G12	M12	125	150	11	45	15	700	65	5	30
4478.G16	M16	170	175	13	45	20	1300	125	1	20
4478.G20	M20	200	190	17	60	23	2000	190	1	15
4478.G24	M24	255	230	21	63	29	3000	340	1	5
4478.G30	M30	255	280	25	90	34	4800	490	1	5

materiál: nerezavějící ocel A4

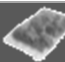
material: stainless steel AISI 316

Kód Art. No.	závit thread	A mm	I mm	U mm	T mm	V mm	nosnost WLL kg	kg/100ks kg/100pcs	 ks pcs	 ks pcs
9478.G05	M5	90	72	125	8	9	90	4,7	5	200
9478.G06	M6	110	88	140	9	10	180	8,8	5	100
9478.G08	M8	110	85	155	10	12	300	14,0	5	100
9478.G10	M10	125	93	180	15	15	500	25,3	5	50
9478.G12	M12	125	88	215	16	17	700	39,1	1	25
9478.G16	M16	170	120	260	21	23	1200	57,7	1	20
9478.G20	M20	200	135	307	23	27	1800	86,3	1	10

Napínák komerční, oko-hák

povrch: galvanický zinkochromát (bílý) > 8µm

materiál: zinková slitina ZAMAK2 ZnAl4Cu3



Turnbuckle commercial, eye-hook

finish: galvanized > 8µm

material: die cast, zinc alloy

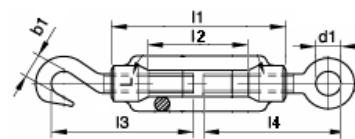

Kód Art. No.	závit thread	l1 mm	l2 mm	l3 = l4 mm	b1 mm	d1 mm	nosnost WLL kg	kg/100ks kg/100pcs	ks pcs	ks pcs
4423.A044	M4	45	25	40	8,5	8	40	1,90	50	1 000
4423.A055	M5	50	30	40	8,5	9	60	3,20	50	500
4423.A057	M5	70	50	50	8,5	9	60	3,70	50	500
4423.A066	M6	60	35	50	10,0	12	90	4,71	50	400
4423.A069	M6	100	70	68	10,0	12	90	6,60	50	300
4423.A087	M8	70	42	57	11,0	12	150	8,32	25	250
4423.A089	M8	110	80	77	11,0	12	150	12,00	25	200
4423.A108	M10	80	50	65	12,0	13	200	15,40	20	140
4423.A112	M10	120	90	88	12,0	13	200	18,80	20	100

- na objednávku se zakončením oko-oko (B), hák-hák (C)

- may be ordered with eye-eye (B), hook-hook (C)

dobací termín 3-4 měsíce od objednání

delivery time 3-4 months from ordering

Napínač drátu - (plotový)

povrch: galvanický zinkochromát (bílý) > 8µm

materiál: ocel S235JR, pevn.tř.4.6, Re 235MPa

Wire tensor

finish: galvanized > 8µm

material: mild steel St 37-2

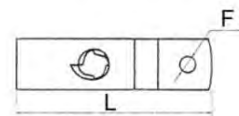
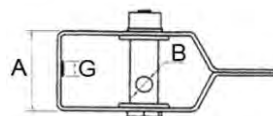

Kód Art. No.	L mm	A mm	B mm	F mm	G mm	kg/100ks kg/100pcs	ks pcs	ks pcs
4424.02	100	30	5	9	7	8,0	50	200
4424.03	120	30	5	9	7	9,4	25	150

povrch: zelený lak

finish: painted green

4425.02	100	30	5	9	7	8,0	50	200
4425.03	120	30	5	9	7	9,4	25	150